

# REF. 4002 5S

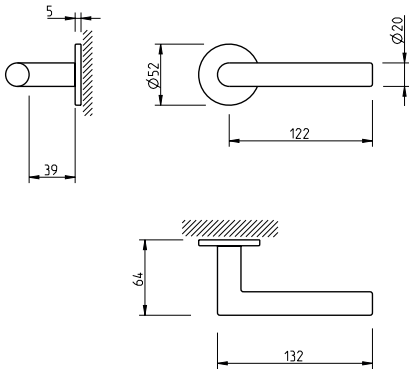

(01) latão polido brilhante polished brass	(03) cromado brilhante bright chrome	(96) cromado satinado satin chrome	(139) anti-alérgico (sem níquel) anti-allergic (nickel free)	(141) titan titan	(142) níquelado pérola nickel pearl	(152) branco pérola white pearl
(153) preto pérola black pearl	(158) purist brass purist brass	(50) PVD latão polido PVD polished brass	(160) PVD cobreado mate PVD matte copper	(161) PVD cobreado brilhante PVD shining copper	(162) PVD antracite PVD antracite	(163) PVD níquelado satinado PVD satin nickel

## Descrição

Puxador par  
Adaptador metálico com sistema "click"  
Mola recuperadora reversível  
Ferro quadrado de 8x90mm  
Fixação da muleta com perno M6 oculto

## Description

Lever set  
Metallic mechanism with "click" system  
Reversible recovery spring  
8x90mm square spindle  
Handle fixed by a M6 grub screw

## Matéria Prima

Latão CW617N

## Raw Material

Brass CW617N

## Aplicação

Portas interiores com 30mm - 45mm espessura

## Application

Interior doors with 30mm - 45mm thick

## EN 1906

2	7	-	0	0	4	0	B
---	---	---	---	---	---	---	---

(acabamentos / finishes 01 - 03 - 50 - 152 - 153  
160 - 161 - 162 - 163)

3	7	-	0	0	4	0	B
---	---	---	---	---	---	---	---

(acabamentos / finishes 96)

2	7	-	0	0	3	0	B
---	---	---	---	---	---	---	---

(acabamentos / finishes 139 - 141 - 142 - 158)